

# Geo- and Environmental Centre (GUZ)

## Location

Schnarrenbergstraße 94-96,  
72076 Tübingen, Germany

## Client

Land Baden-Württemberg,  
represented by Vermögen  
und Bau Baden-  
Württemberg, Amt Tübingen

## Initiated

2013

## Completion

2020

## Size

20 700 sqm

## Project Team

Tjerk de Boer, Marc Coma,  
Sebastian van Damme,  
Cecilia Dobos, Ana Rivero  
Esteban, Ahinitze Errasti  
Etxeberria, Paolo Faleschini,  
Michael Geensen, Marlon  
Jonkers, Kees Kaan, Jan  
Teunis ten Kate, Moritz  
Kühl, Nicki van Loon, Loes  
Martens, Hrvoje Šmihelc,  
Hannes Ochmann, Vincent  
Panhuisen, Maurizio Papa,  
Dikkie Scipio, Katarzyna  
Seweryn, Floris Sikkel,  
Christian Sluijmer, Davide  
Spina

## Photos

Brigida Gonzalez

## Collaborators

[full list available here](#)



Geo- and Environmental Centre (GUZ) is a state of the art facility for interdisciplinary research into solutions for environmental problems, located at the Eberhard Karls University in Tübingen. Its prominent location complements the campus' urban layout and underlines the Centre's scientific importance as it brings together the previously scattered departments. The combined facility aims to stimulate exchange between individual departments in the building and other natural science faculties located in the area. Partially recessed into the site's slope, the building is a low elongated structure spreading over six floors. Within its 100 by 50 m footprint, it encloses two courtyards laid out on different levels to cope with the inclined topography of the site. Geo- and Environmental Centre combines public teaching and study areas with specialised research and workspaces. Conveniently located communal facilities like the auditorium and seminar rooms in the north are easily reached from the campus square. The labs and workshops face east, with offices lining the west and south. The specialised activities of the Centre are on display between the seemingly solid concrete bands, making the building look like a block of stone with deep ridges that expose a glazed volume.

# Geo- and Environmental Centre (GUZ)

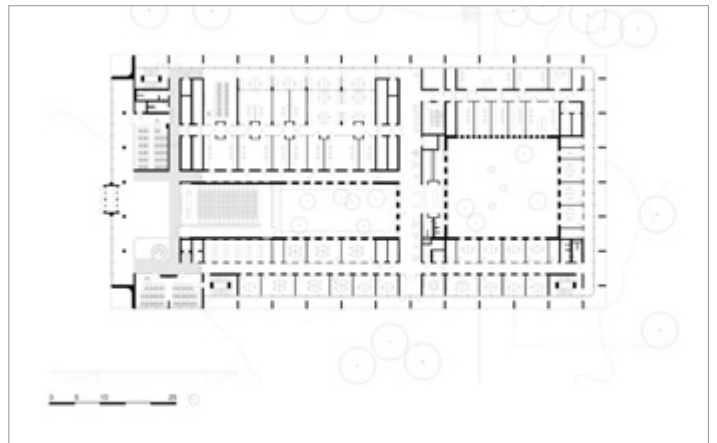
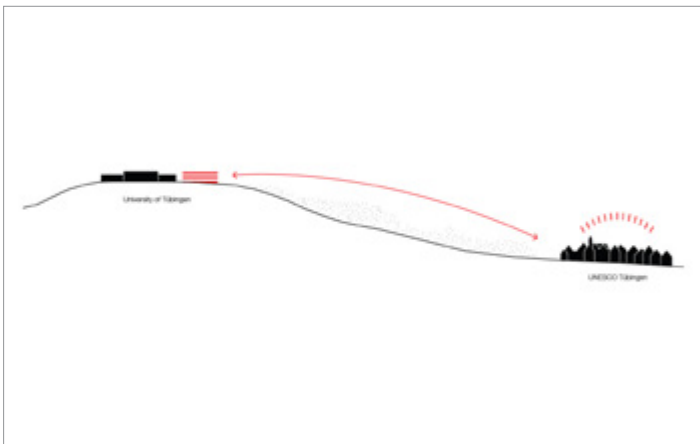

# Geo- and Environmental Centre (GUZ)

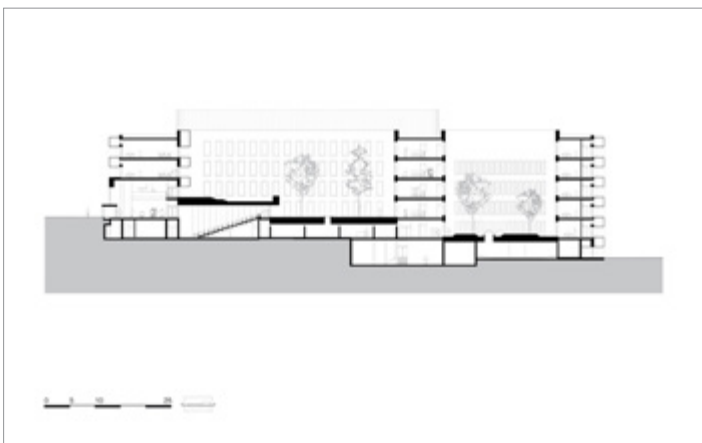
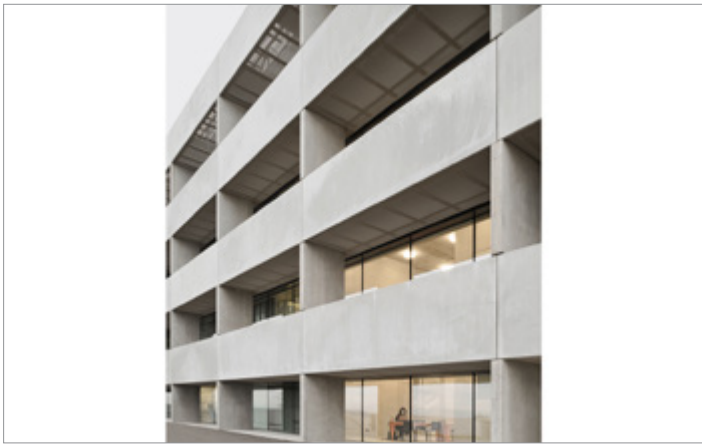
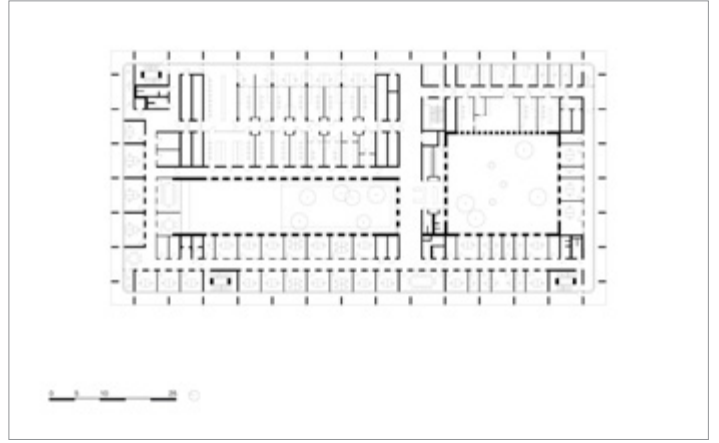

# Geo- and Environmental Centre (GUZ)

